

Alexandria Higher Institute of Engineering & Technology (AIET)

Industrial Engineering Department

1st Year

ME 141

Machines drawing

Final, August, 24, 2010

Examiners:

Dr. Rola Afify

Time: 3 hours

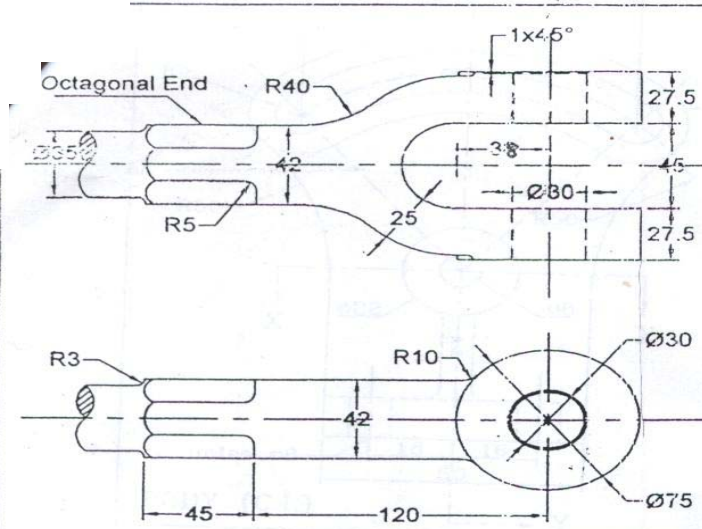

FORK (ST.)

No. OFF 1

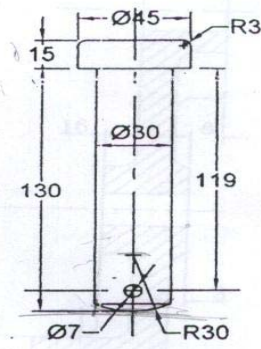

PIN (ST.) No. OFF 1

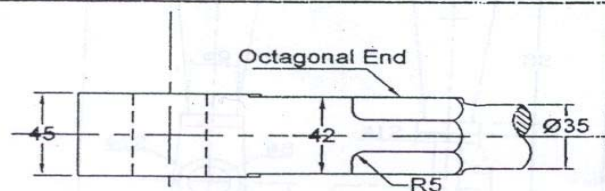

EYE ROD (ST.)

No. OFF 1

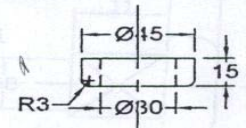

WASHER (ST.)

No. OFF 1

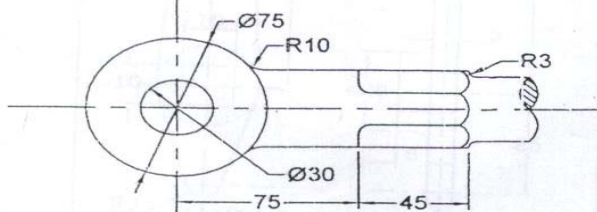

SPLIT PIN (ST.)

No. OFF 1

You are given the details of KNUCKLE JOINT. Assemble all parts and draw the following views:

- SEC. ELEVATION
- PLAN

Scale 1:1 and all dimensions in mms. All unspecified radii are R3.

Good Luck